



EN

Stickpack CS





extreme accessibility

Access to CS equipment is amazingly easy since it is provided with a series of **assembly/disassembly assisted systems such as fillers, sealing and reel lifting groups.**

Consequently accurate and user-friendly design allows operator and MNT technician to get access to any part and component without any difficulty so to implement easily any cleaning, parts replacement and control.

easy cleaning

Parts in contact with product in stainless steel. Mirror polished surfaces.

Accurate design of each single detail in order to prevent any product deposit. All above features make CS packaging machine an extremely easy equipment to clean, with negligible time consumption.

balcony and compact design

The stick-pack Machine Mod. CS is designed for an immediate and easy use.

The balcony design, the easy accessibility, the absence of external cables, leaning outside mechanical components make the equipment fully compliant with the most stringent GMP requirements.

The lower number of components fitted on give the machine a really compact design allowing the placement in absence of space.





auger dosing system

Multi-lane Auger Filler especially designed for powdery products with poor flowability.

The Unit is equipped with a Pre-feeding Group for a smooth and constant feed of the product into the dosing chamber, allowing high accuracy.

All parts in contact with the product are in stainless steel and mirror polished to avoid any product residue deposition.

The Feeding Hopper is provided with a special stirring system able to avoid any phase separation of the product.

State of the Art Dosing Auger is driven by its own Brushless motor allowing fine adjustment on each lane.

Dosing Tubes Cooling System for optimal treatment of heat sensitive products.

The Dosing System can be easily removed by means of an automatic lifting device guaranteeing extreme accessibility and cleaning.

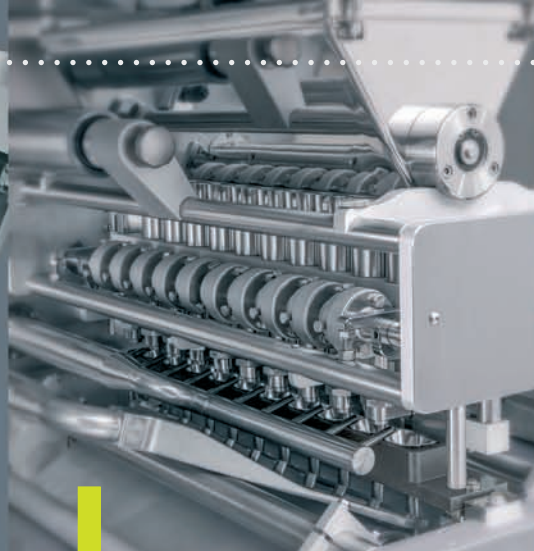

volumetric dosing system

Oscillating Dosing Cups System for free-flowing and granular products.

The Group is installed on a sliding support that allows to remove and clean it easily without using any mechanical tool.

It is designed with:

- Centralized dosing chamber adjustment;
- Single dosing cup adjustment.

CS machines can be equipped with a new "Vacuum-phases" Dosing System aimed to ease the release of non free-flowing products and to guarantee non contaminated and tight seals (**patented system**).

All parts in contact with the product are in stainless steel and FDA approved material.



liquid/pasty dosing system

Filling System to dose liquid and pasty products.

Hopper and Dosing Tubes designed with Clamp Connection for quick disassembly and cleaning.

It is driven by Brushless Motor for fine adjustment.

CIP Equipment for assisted cleaning of the Dosing Unit.

complete stick packaging line

Complete stick packaging line for medium or high speed production complete with automatic feeding system Mod. S1 for stick counting to the down-stream cartoner.

Stick pick-up system, placed below the horizontal cutting area.



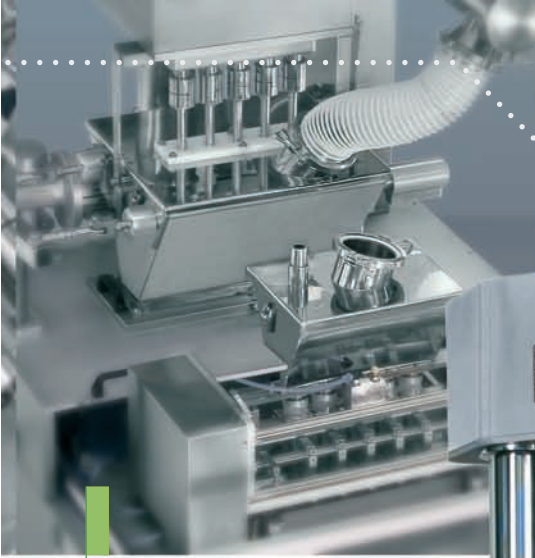

CS

stick intermittent motion
vertical form/fill/seal
packaging machine

double feeding system

Thanks to the extreme accessibility, CS allows to install two dosing systems to be used alternatively



Stick positive transport to the Counting Station.

Pick-up Heads and Stick transfer system to the buckets of a cartoner.

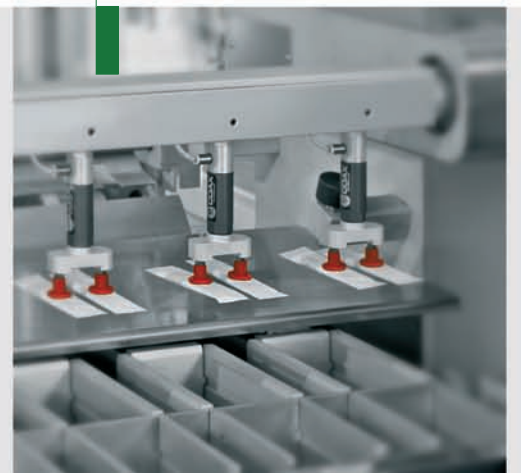
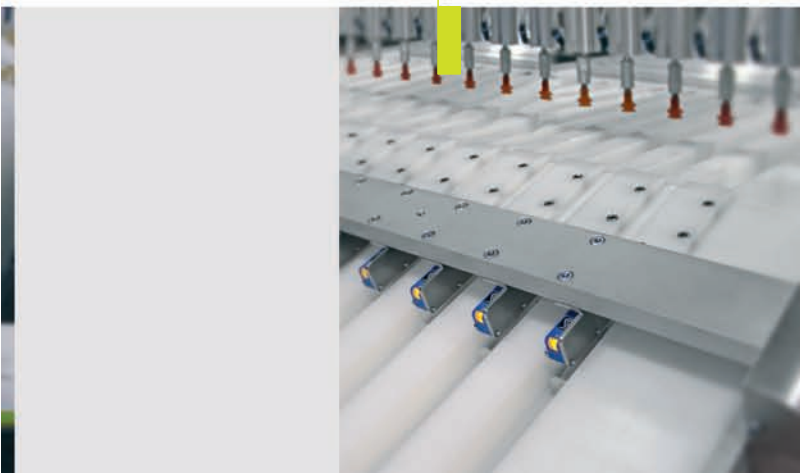

easy access to the sealing and cutting groups

All the groups for the vertical/horizontal sealing and for the cutting have an easy access to be cleaned and removed.



laser stick coding system

CS can be equipped with any thermal ink-jet printer or laser device.

Linear actuator for horizontal traverse of one or more printing heads for sticks coding, by installing 1 printing head on a motorized support allowing movement inversion (the printing head can mark in both senses).



stick counting and deposit in bulk

CS can be connected to a counting group to release sticks into cartons. Available also in automatic version with carton closer (by tape or glue).

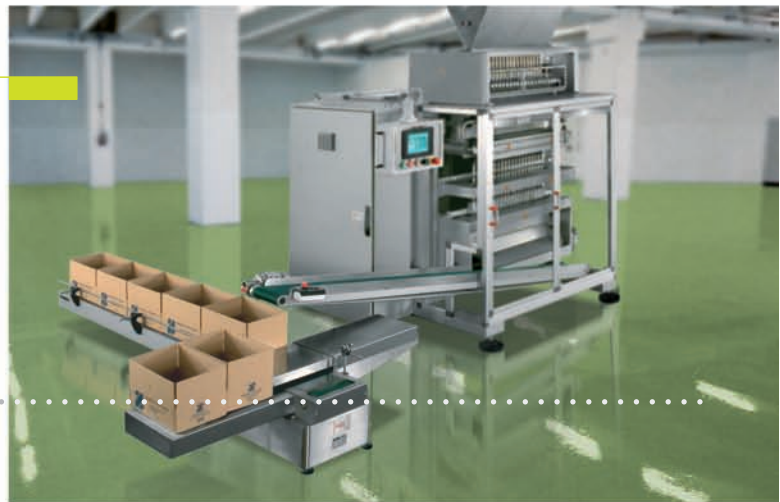

stickpack CS / specifications

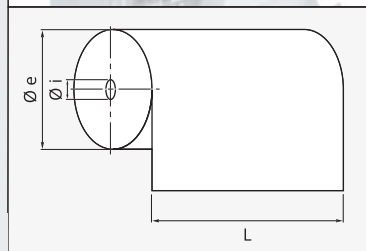
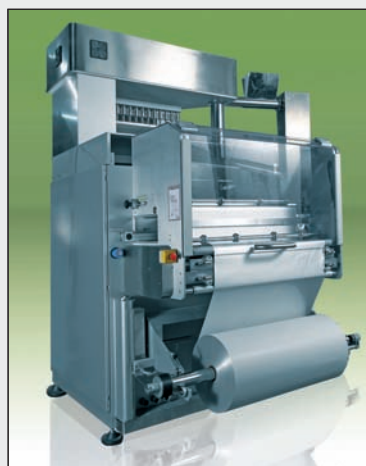
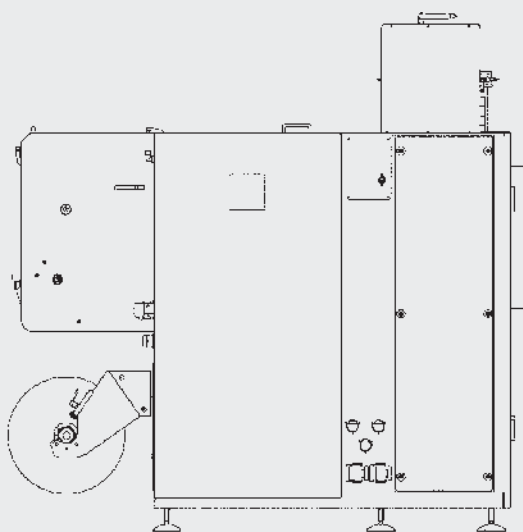
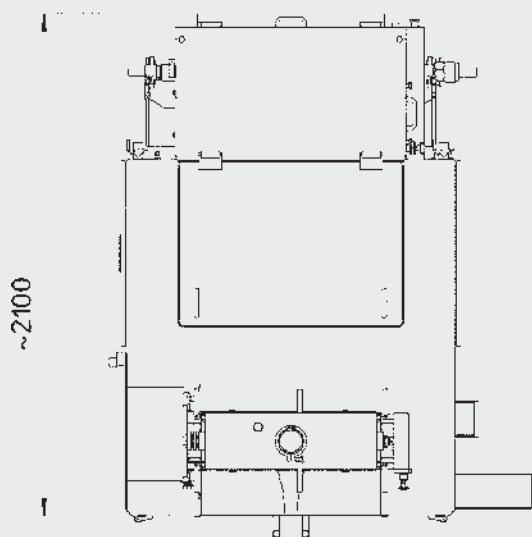
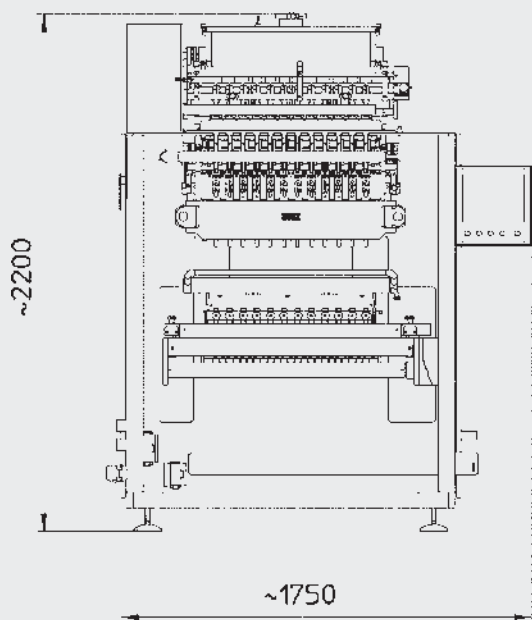

Technical data

| | |
|-----------------|--------------------|
| absorbed power | ~ 4 kW |
| air consumption | ~ 500 NI/min 6 bar |
| net weight | ~ 2000 kg |

Reel size range

| | |
|-----|---------------------------|
| Ø e | min - max = 500 - 800 mm |
| Ø i | min - max = 76 - 150 mm |
| L | min - max = 600 - 1200 mm |

OMAG reserves the right to update, change, modify or otherwise alter technical features and descriptions reported in this brochure at any time, based on future technical innovations and markets evolving requirements.